

Screening Tool for Coronavirus Disease 2019 (COVID-19 Testing)

Patient Name: _____ DATE: _____ TIME: _____ AM PM
 Telephone number: _____ Provider / Nurse: _____

Bristow Medical Center is following the guidance of the Centers for Disease Control and Prevention (CDC) for "Criteria To Guide Evaluation of Persons under Investigation for COVID-19" at: <https://www.cdc.gov/coronavirus/2019-nCoV/hcp/clinical-criteria.html>.

Step 1

**At Front Desk:
Ask both questions**

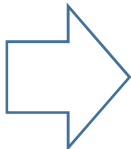

Clinical Features	
Have you had a fever?	<input type="checkbox"/> Yes <input type="checkbox"/> No
Have you had cough, congestion, difficulty breathing, etc.?	<input type="checkbox"/> Yes <input type="checkbox"/> No

If patient answers **"Yes"** to either of these two questions, proceed to Steps 2 & 3

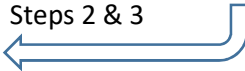

If the patient answers **"No"** to both of the above



The patient may proceed with-normal check-in process. Documentation of the COVID-19 screening should occur during the triage/intake process.

Step 2

If it can be done safely, patient should return to car, and assessment can continue by telephone. If further evaluation for an emergent condition is required, the patient and all healthcare personnel should wear a mask.

Step 3

Ask both questions



Epidemiological Risk	
Have you traveled to an affected area in the past 14 days? (Check this information daily.)	<input type="checkbox"/> Yes <input type="checkbox"/> No
Have you had close contact with a person who has had a confirmed diagnosis of COVID-19?	<input type="checkbox"/> Yes <input type="checkbox"/> No
Have you had close contact with an ill person being evaluated for COVID-19?	<input type="checkbox"/> Yes <input type="checkbox"/> No

If patient answers **"Yes"** to **EITHER** of these questions ...

Notify ER provider immediately of patient's positive screening result.



If patient answers **"No"** to **BOTH** of these questions ...

The patient may proceed with-normal check-in process. Documentation of the COVID-19 screening should occur during the triage/intake process.

